

- NOTES:**
- ALL WORKS TO BE CONSTRUCTED IN ACCORDANCE WITH THE NEW SPECIFICATION FOR ROAD WORKS UNLESS OTHERWISE BY LOCAL OVERSEING AUTHORITY'S STANDARDS.
 - ALL ROAD MARKINGS & SIGNS SHALL COMPLY FULLY WITH THE ROAD MARKINGS & SIGNS MANUAL ISSUED BY THE DEPARTMENT OF TRANSPORT, NOVEMBER 2015.
 - SIGNS & MARKINGS CONTRACTOR TO OBTAIN PRECISE SETTING OUT WITH EMPLOYERS REPRESENTATIVE PRIOR TO COMPLETION.
 - ALL SIGNS TO BE MOUNTED ON 75mm GALVANIZED STEEL POSTS WITH COLOURED SLEEVES LEAD TO SPECIFICATION AND IN ACCORDANCE WITH THE TRAFFIC SIGNS MANUAL. MOUNTING HEIGHT TO BOTTOM OF SIGN = 2.3m LEAD.
 - ALL TRAFFIC MANAGEMENT TO COMPLY FULLY WITH THE PROVISIONS OF CHAPTER 8 OF THE TRAFFIC SIGNS MANUAL.
 - ALL CO-ORDINATES ARE TO BE TAKEN FROM THE PROPOSED STREET FURNITURE TO BE TAKEN UP AND SET ASIDE FOR RE-USE. PROPOSED STREET FURNITURE TO BE REPOSITIONED BY OWNERS.
 - ALL EXISTING SIGNS (INCLUDING POLES) AND MARKINGS TO BE TAKEN UP OR COVERED AND TEMPORARY MEASURES APPLIED IN ACCORDANCE WITH CONTRACTORS TRAFFIC MANAGEMENT PLAN. THE CONTRACTOR SHALL BE RESPONSIBLE FOR CLEARING OBSTRUCTION THROUGHOUT WORKS. OWNERS SHALL BE RESPONSIBLE FOR POSITIVE IDENTIFICATION OF FINISHING WORKS DRAWING.
 - ALL EXISTING SIGNAGE AND VEHICULAR ROUTES MUST BE RETAINED IN ACCORDANCE WITH APPROVED TRAFFIC MANAGEMENT PLAN.
 - ALL MATERIALS TO BE DEPOSITED OFF SITE SHALL BE TAKEN TO A LICENSED FACILITY APPROVED BY THE LOCAL AUTHORITY DEPARTMENT AS DIRECTED IN THE WORKS REQUIREMENTS.
 - THE CONTRACTOR MUST Liaise DIRECTLY WITH LOCAL AUTHORITY DEPARTMENT AS DIRECTED IN THE WORKS REQUIREMENTS.
 - ALL VEHICULAR & PEDESTRIAN CYCLE & PRIVATE ACCESS ROUTES WITHIN AND SURROUNDING THE WORKS EXTENTS MUST BE MAINTAINED THROUGHOUT THE WORKS IN ACCORDANCE WITH THE CONTRACTOR'S APPROVED TEMPORARY TRAFFIC & OPERATORS MANAGEMENT PLAN.

- LEGEND:**
- PROPOSED ROAD
 - PROPOSED FOOTPATH
 - PROPOSED BUILDINGS
 - PROPOSED PERMEABLE PAVING
 - PROPOSED BASEMENT RAMP
 - PROPOSED SHARED ZONE (VEHICLE PEDESTRIAN)
 - PROPOSED OFF-ROAD CYCLE TRACK
 - BOLLARD
 - REMOVABLE BOLLARD
 - PROPOSED ROAD GRADIENT
 - EXISTING LEVELS
 - PROPOSED ROAD LEVELS
 - FINISHED FLOOR LEVEL
 - SITE BOUNDARY
 - DROPPED KERB
 - PROPOSED BUILDING STEPS
 - RAMP/UNCONTROLLED PEDESTRIAN CROSSING
 - PROPOSED SIGNBOARD

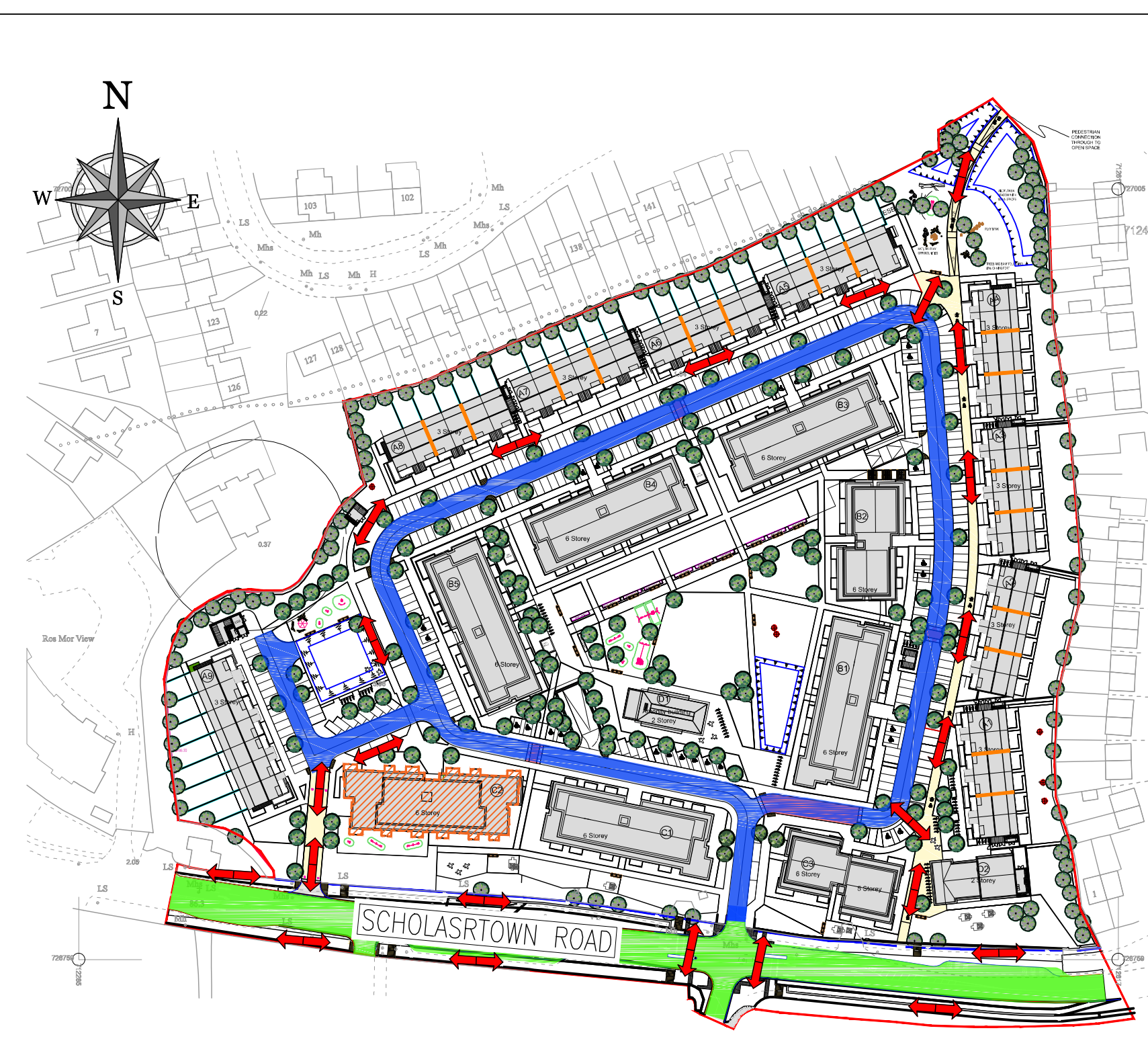

- LEGEND:**
- PROPOSED LOCAL STREET
 - EXISTING ARTERIAL ROAD (SCHOLARSTOWN ROAD)
 - PROPOSED PEDESTRIAN / CYCLE ROUTE

ROAD / STREET HIERARCHY PLAN SCALE 1:1000

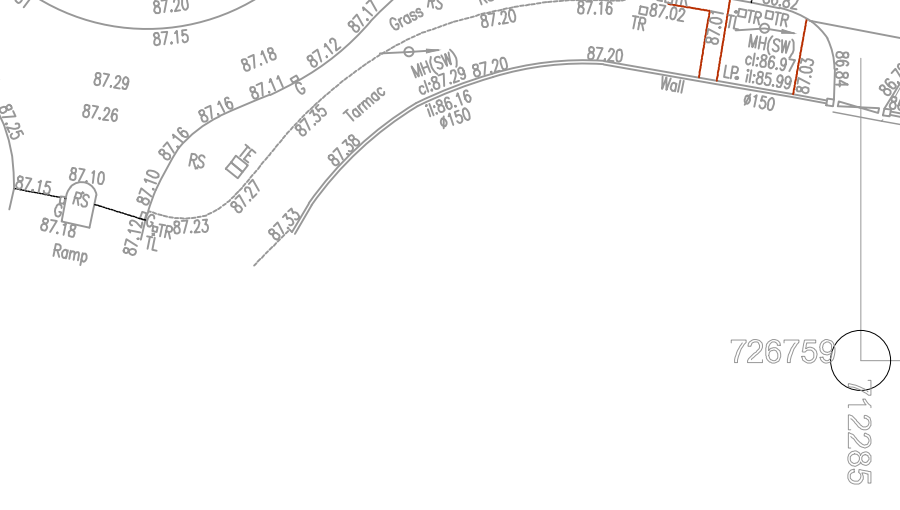
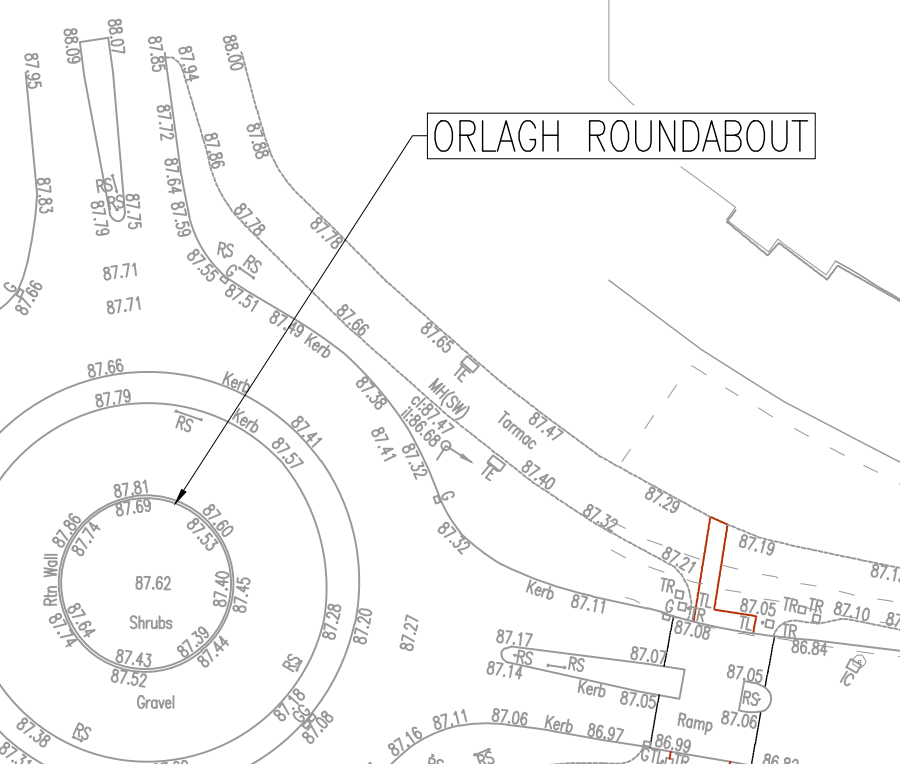
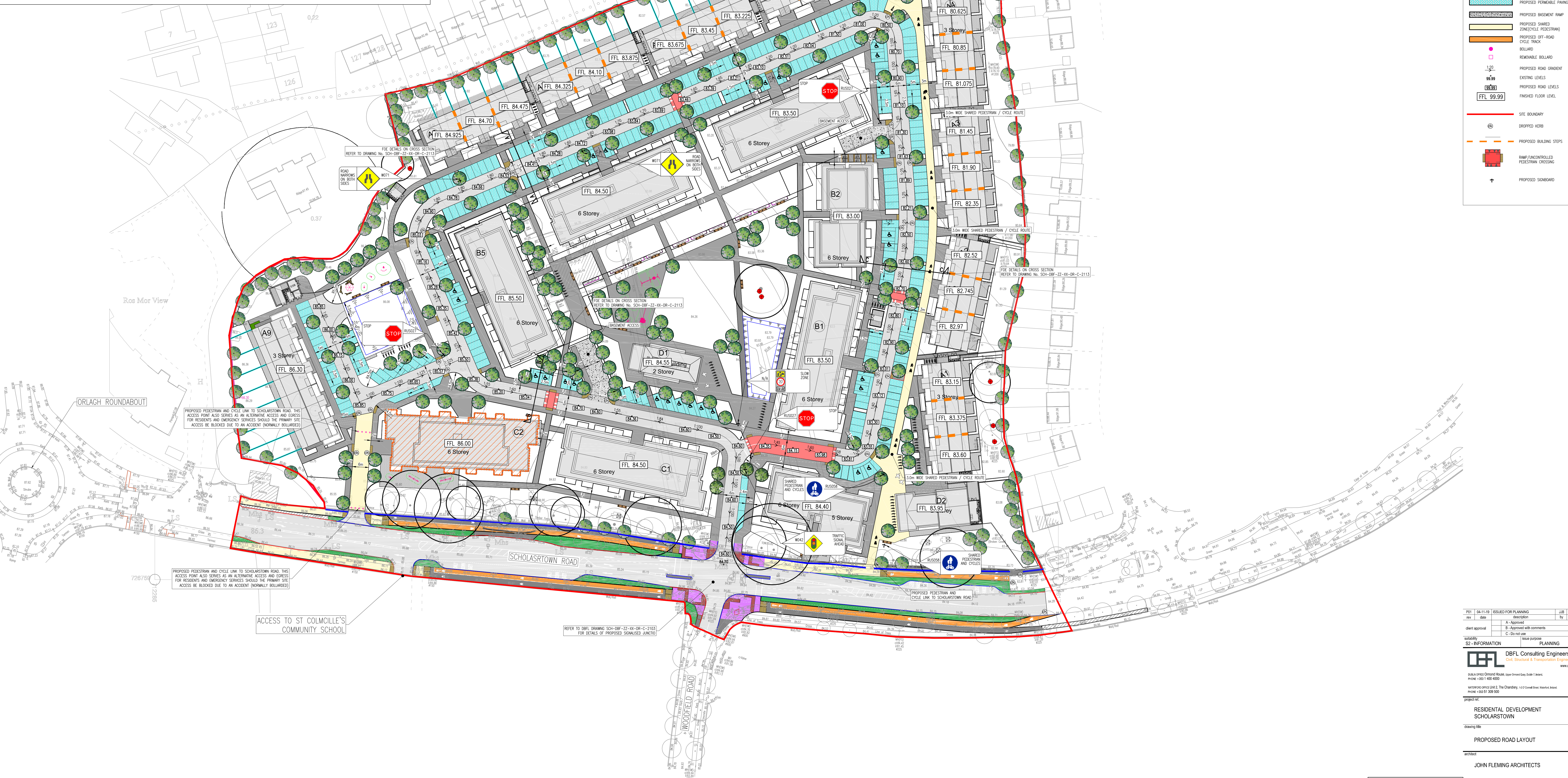

DBFL Consulting Engineers
 Civil Structural & Transportation Engineering
 www.dbfl.ie

100, South Circular Road, Dublin 8, Ireland
 Phone: +353 1 401 4000

100, South Circular Road, Dublin 8, Ireland
 Phone: +353 1 208 500

PROJECT REF: RESIDENTIAL DEVELOPMENT SCHOLARSTOWN
 DRAWING NO: PROPOSED ROAD LAYOUT
 ARCHITECT: JOHN FLEMING ARCHITECTS